

Magnetic band filters - series PBMA

Use

Magnetic band filters are used for the fully automatic continuous cleaning of cutting fluids with high requirements on the purity level and when machining ferrous, magnetic materials with large quantities of chipping.

Constructions and operation

Magnetic band filters consist of a series PB band filter with a series MA magnetic separator positioned in front of it.

The medium to be cleaned passes from the machine into the infeed tank (1) of the magnetic separator (2). The rotating magnetic roller (3) immediately removes the vast majority of the ferrous magnetic impurities and moves them, after dry crushing them with the pressure roller (4), through the wiper plate (5) into a sludge box (6). A baffle plate (7) feeds the medium thus cleaned to the band filter (8). The medium passes through a trough-shaped filter fleece by means of gravity during which the remaining impurities, even those which are not magnetic, are filtered out. The filter cake thus formed has a positive influence on the filter fineness. The increasing saturation level trips the transport of the filter fleece via the float switch (9), the control electrics (10) and the geared motor (11).

The used filter fleece is transported into the sludge box and new filter fleece inserted into the filter trough (the sludge box is not supplied as standard).

Materials and application

Band filter:	sheet steel with corrosion protection, Aluminium cast
Filter material:	Fleece made of viscose rayon
	Other non-woven are available on request.
Magnetic separator casing:	Aluminium cast

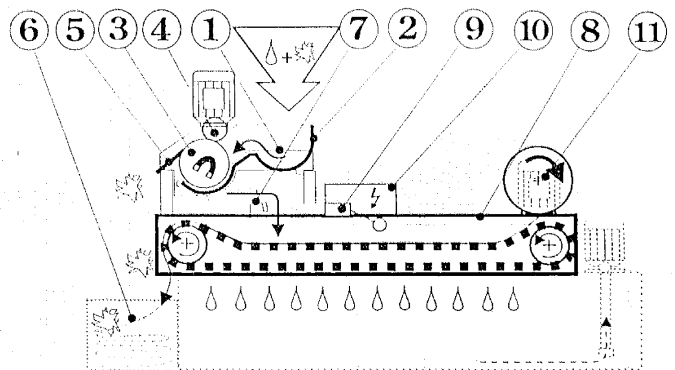

Magnet body:
Pressure roller:

Oxide ceramic
Rubber, oil-resistant

Cleaning

When cleaning the unit, the relevant accident prevention regulations and the environmental directives must be observed. If the unit is to be at a standstill for any length of time we recommend that the magnetic roller and the casing are cleaned first.

Example order

Magnetic band filter for a capacity of up to 120 l/min with a viscosity of up to 6 mm² /s:

Magnetic band filter PBMA 126

To order the PBMA series can be supplemented with a coolant tank, pumps, sludge box, electrical system, etc. and can also be supplied as complete filter systems (see information sheet entitled "Filter systems with magnetic band filters").

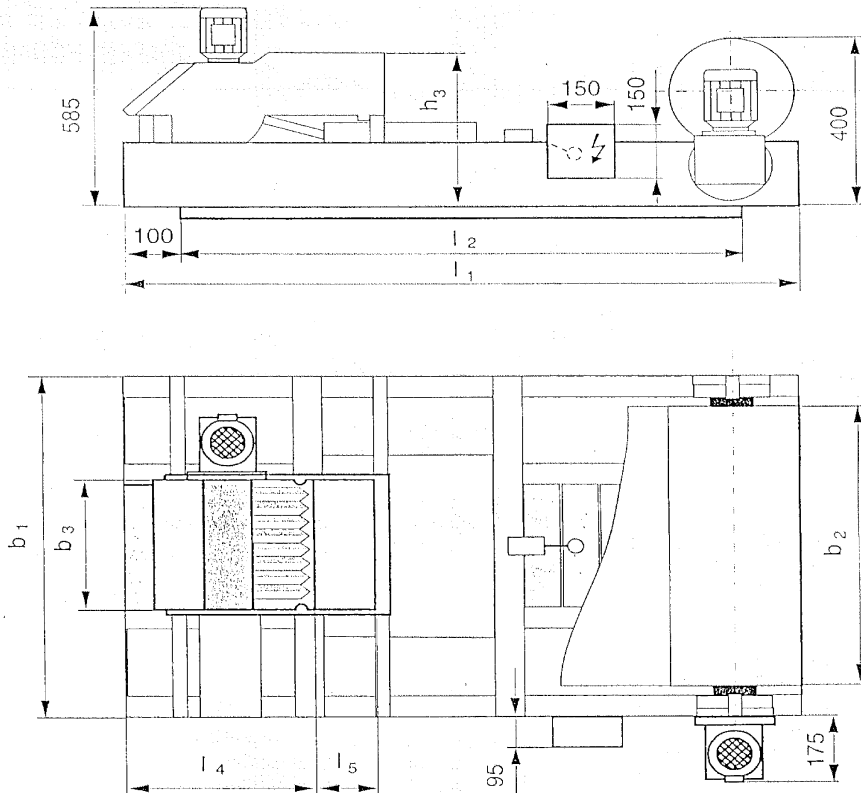

Type			PBMA40	PBMA60	PBMA120	PBMA250
Filter material	Average outfeed fineness μm	Capacity l/min (up to $6\text{mm}^2/\text{s}$)				
HSPP 035	60-80		60	80	160	320
HSPP050	30-40		40	60	120	250
l1			1000	1240	1800	2400
l2			800	1040	1600	2200
l4			360	360	370	370
l5			130	130	190	190
b1			500	720	970	1400
Filter area m^2			0,3	0,5	1,0	2,0
Filter fleece width b2			430	650	900	1330
b3			180	180	460	2x460
h3			420	420	450	450
Drive	Geared motor					

Connection DIN IEC 38 230 / 400V AC 50 Hz

For other voltage ask us

2003 edition Technical data and illustrations are non-binding; we reserve the right to modify the design.